

RE040

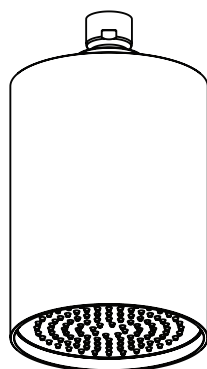

RE041

ISTRUZIONI DI MONTAGGIO
INSTALLATION INSTRUCTIONS

1

CONTENUTO CONFEZIONE PACKAGE CONTENTS

RE040

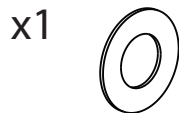
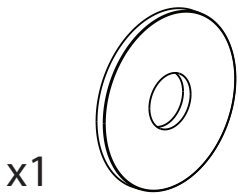
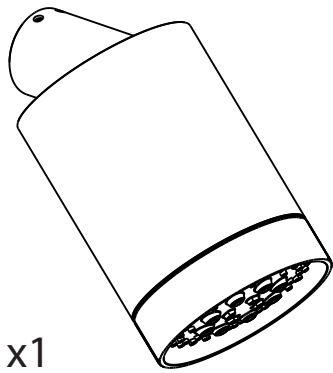

MIN 1 Bar
MAX 5 Bar
BEST 3 Bar

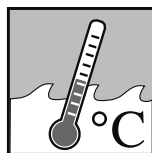

MAX 70° C
BEST 38/40° C

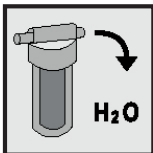

ATTENTION!
*

| IT | * SI CONSIGLIA L'INSTALLAZIONE DI UN FILTRO A MONTE DELL'IMPIANTO
| GB | * WE RECOMMEND INSTALLING A FILTER UPSTREAM OF THE PLANT

2

CONTENUTO CONFEZIONE PACKAGE CONTENTS

RE041

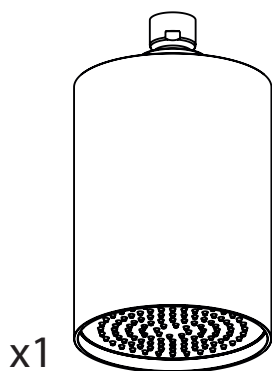

MIN 1 Bar
MAX 5 Bar
BEST 3 Bar

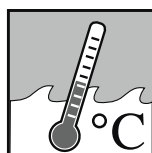

MAX 70° C
BEST 38/40° C

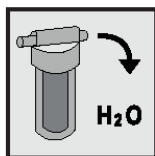

ATTENTION!
*

| IT | * SI CONSIGLIA L'INSTALLAZIONE DI UN FILTRO A MONTE DELL'IMPIANTO
| GB | * WE RECOMMEND INSTALLING A FILTER UPSTREAM OF THE PLANT

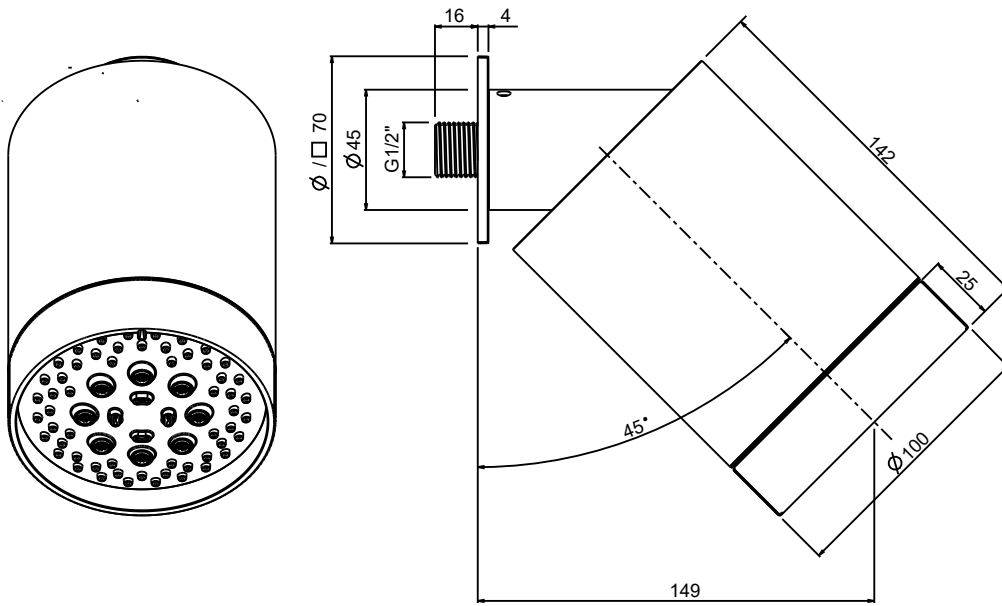

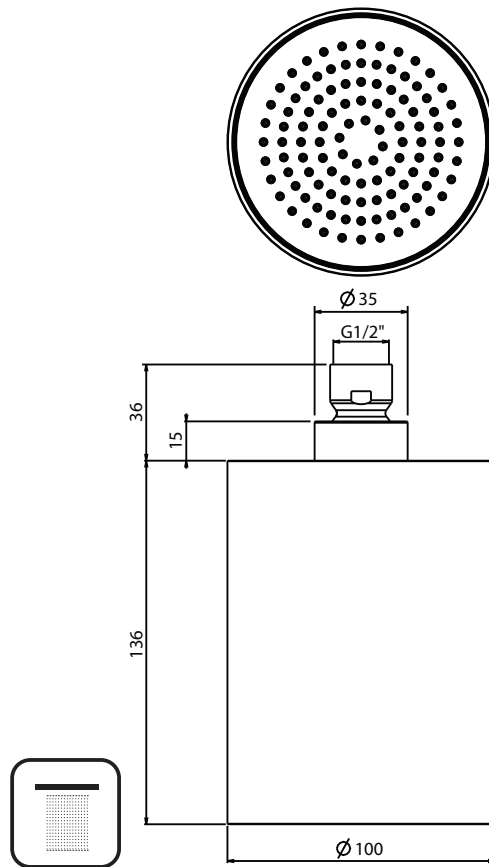

INCLINAZIONE REGOLABILE
ADJUSTABLE INCLINATION

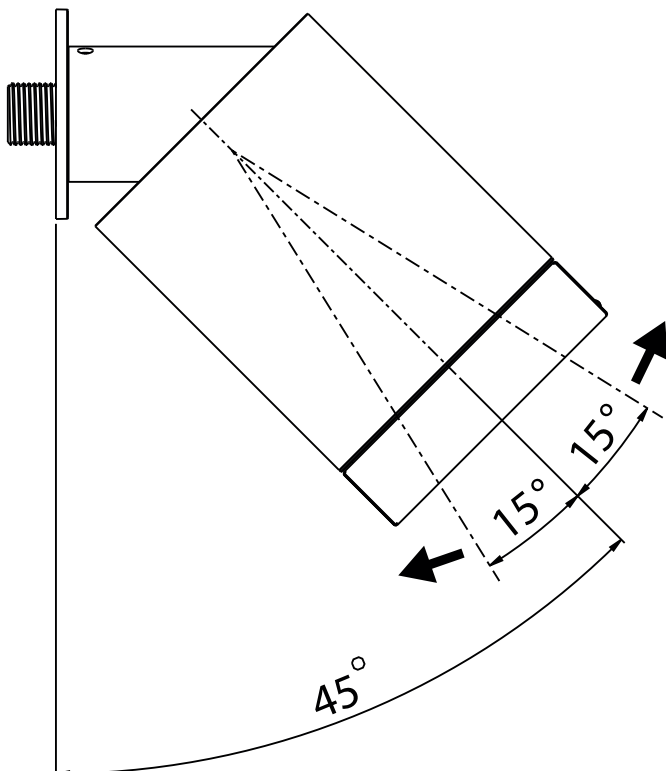

RUOTARE ANELLO PER SELEZIONE GETTI
TURN RING TO SELECT JETS

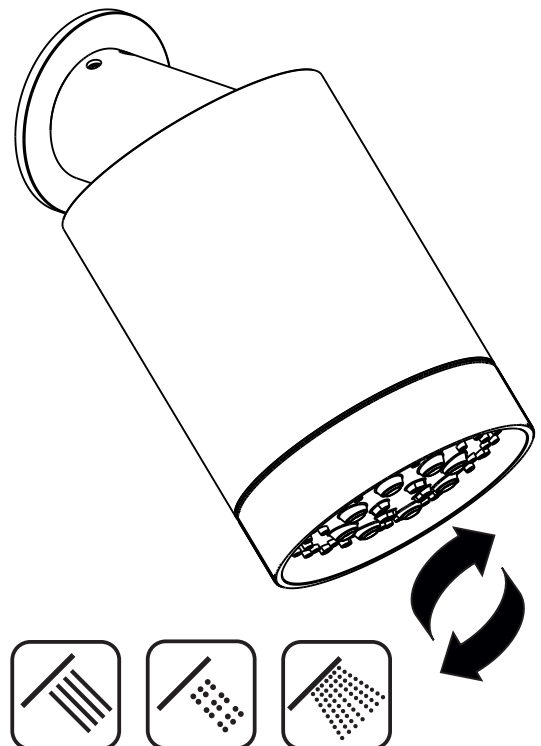

ART. RE040: TABELLA PRESSIONE (BAR) / PORTATA (L/MIN)
ART. RE040: PRESSURE (BAR) / FLOW RATE (L/MIN) CHART

BAR	0,5	1	1,5	2	2,5	3	3,5	4	4,5	5
L/MIN (RAIN)	3,8	5,6	6,8	7,7	8,5	8,9	9	8,5	8,5	8,4
L/MIN (AIRY)	2,8	4,1	5	5,8	6,4	7	7,6	8,1	8,5	8,9
L/MIN (MASSAGE)	2,5	3,6	4,4	5,1	5,8	6,4	6,8	7,3	7,7	8,2

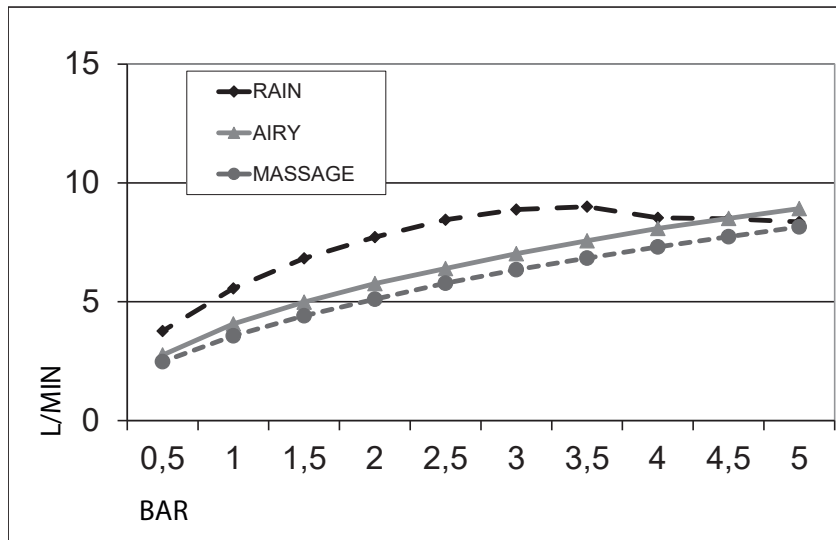

ART. RE041: TABELLA PRESSIONE (BAR) / PORTATA (L/MIN)
ART. RE041: PRESSURE (BAR) / FLOW RATE (L/MIN) CHART

BAR	0,5	1	1,5	2	2,5	3	3,5	4	4,5	5
L/MIN	3,8	5,4	6,1	6,2	6	6,1	5,9	5,9	5,9	5,9

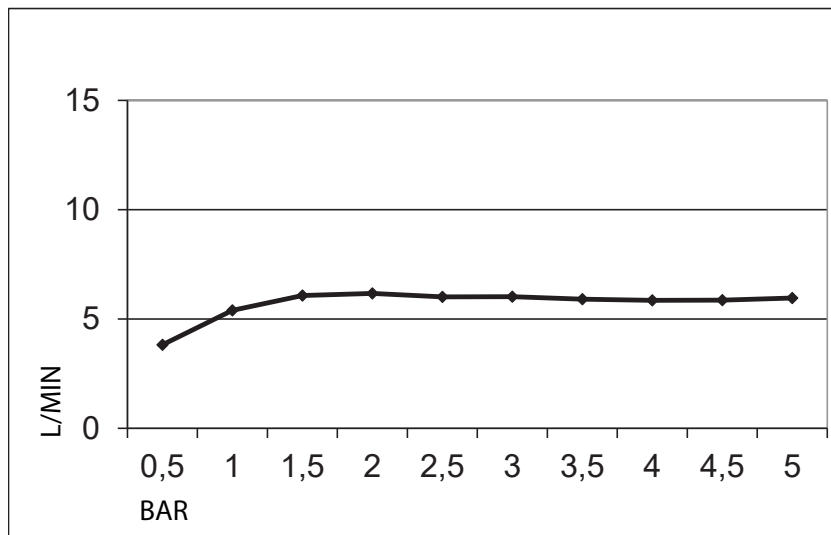

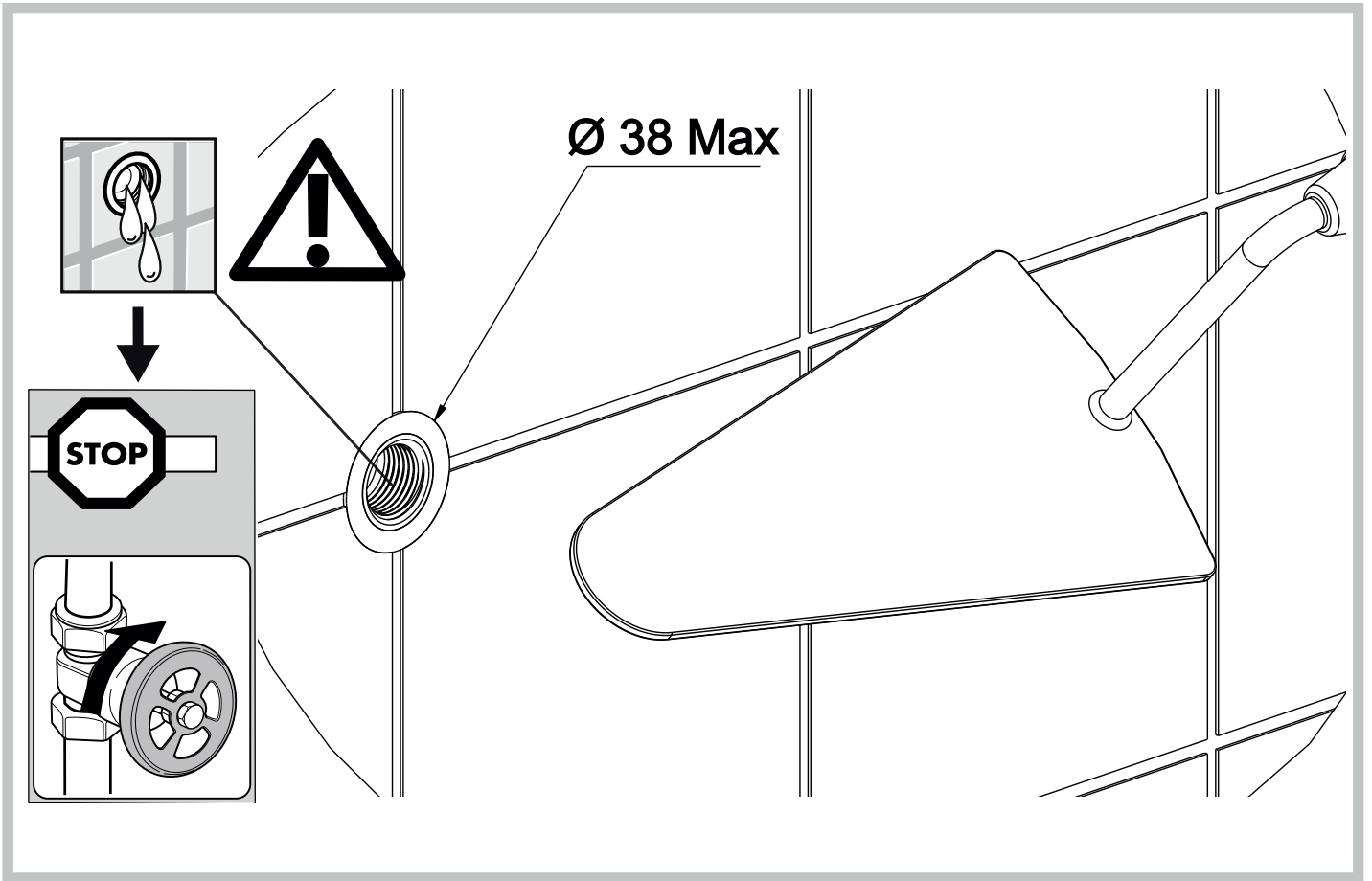

IL SOFFIONE PUO' ESSERE INSTALLATO CON O SENZA ROSONE
THE SHOWER HEAD CAN BE INSTALLED WITH OR WITHOUT ROSETTE

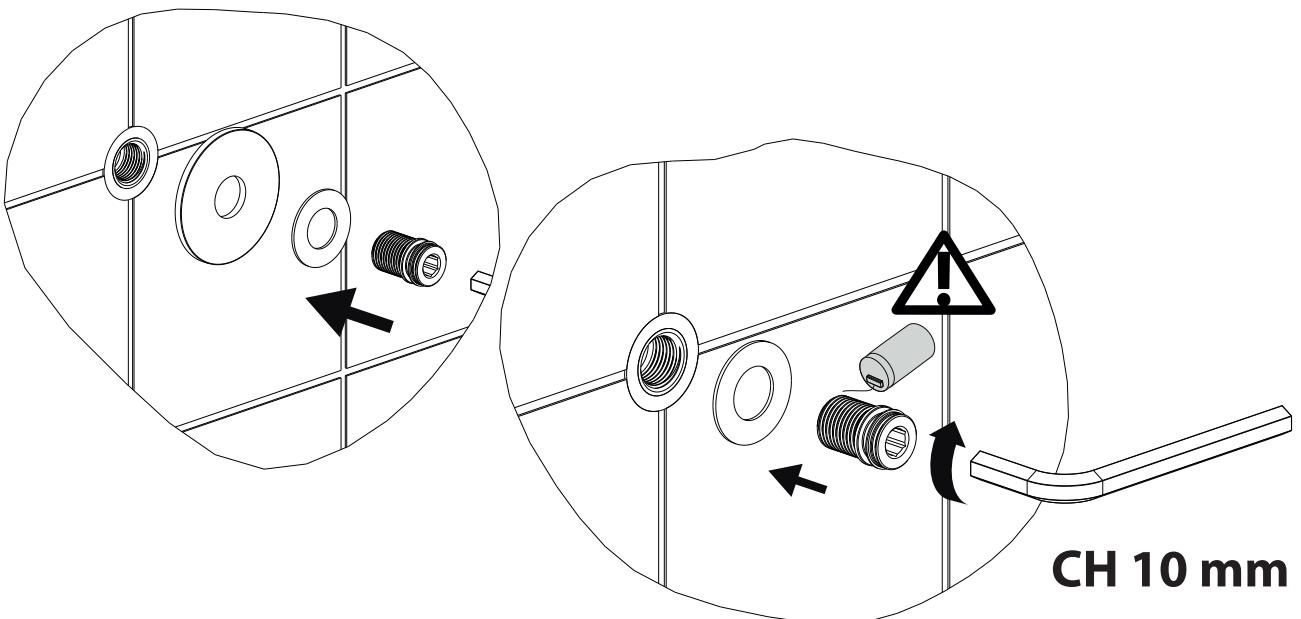

INSTALLAZIONE ART. RE040

INSTALLATION ART. RE040

IL SOFFIONE PUO' ESSERE INSTALLATO CON O SENZA ROSONE
THE SHOWER HEAD CAN BE INSTALLED WITH OR WITHOUT ROSETTE

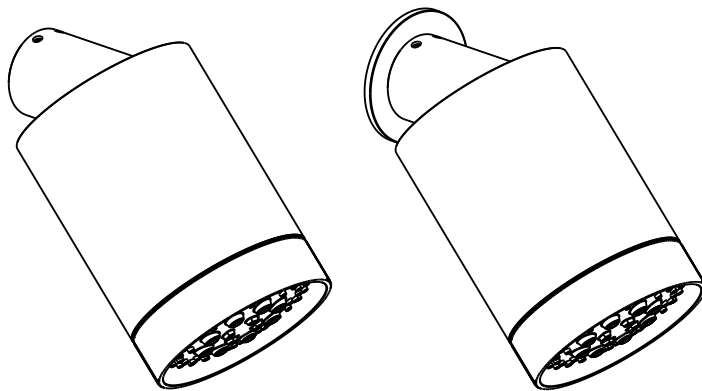
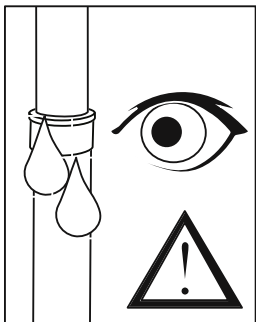
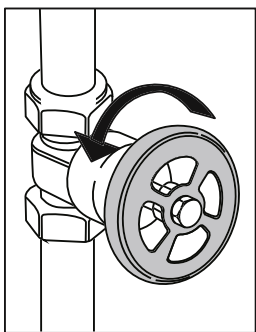
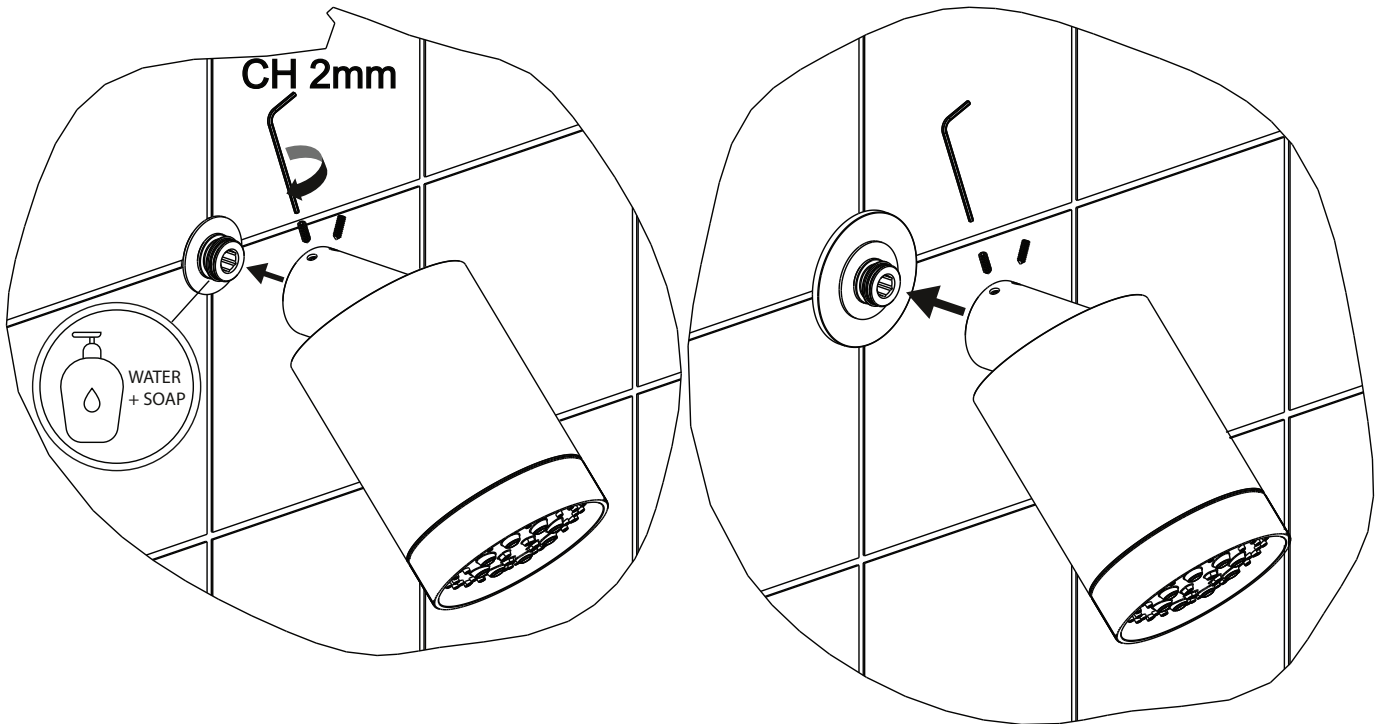

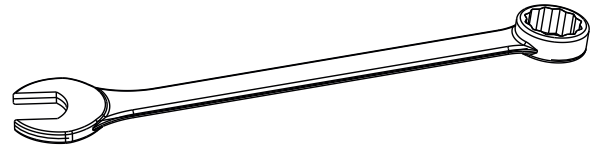
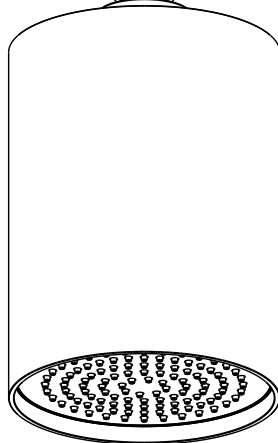
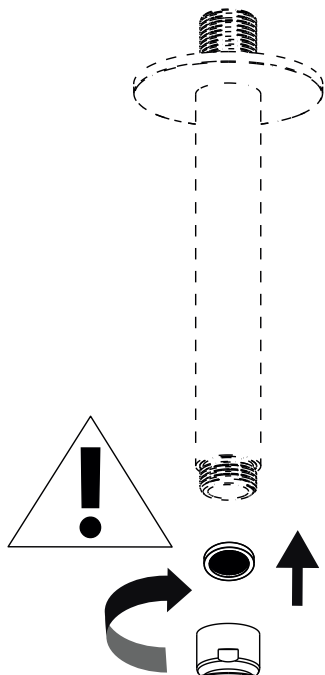
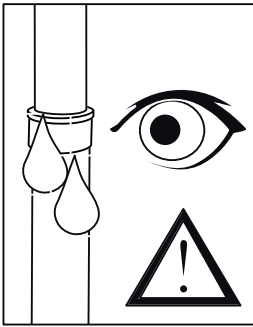
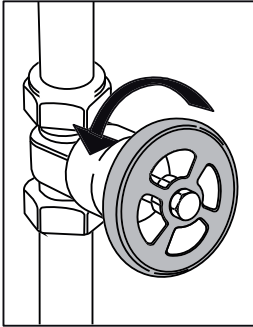

CH 22 mm

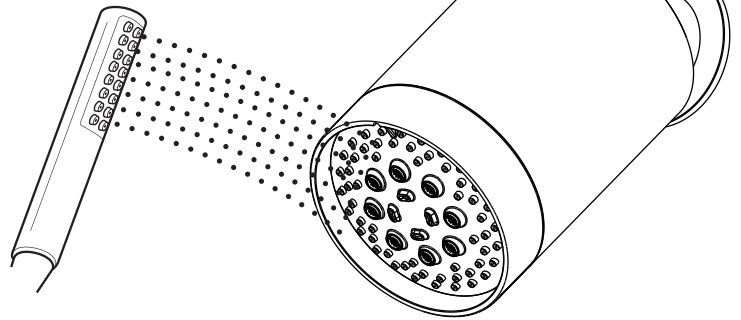
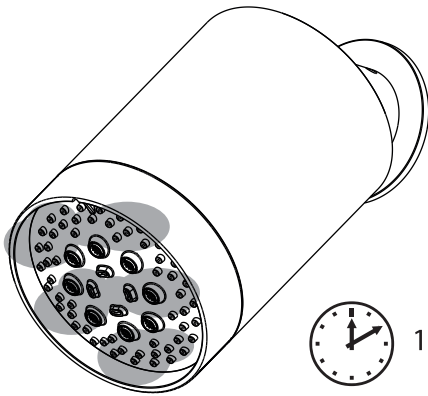
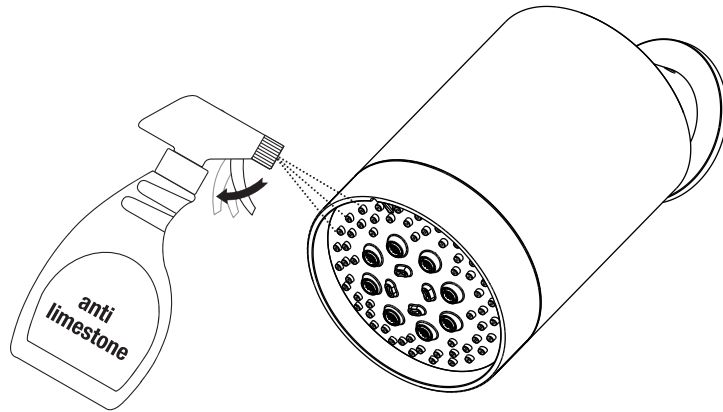



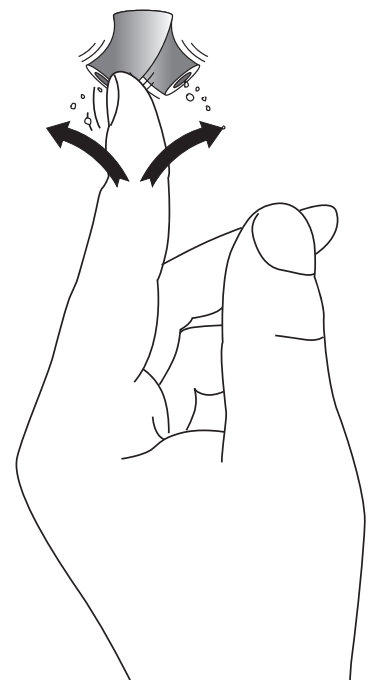
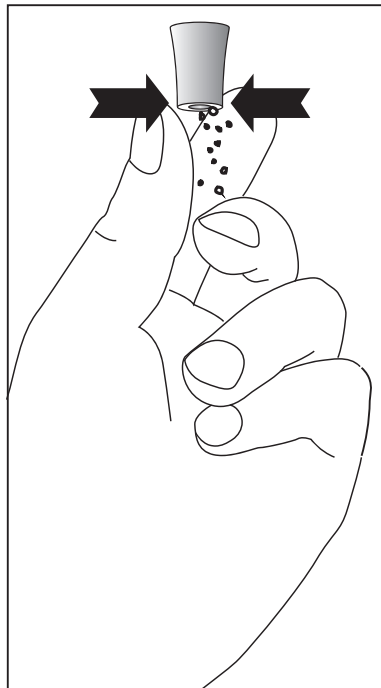
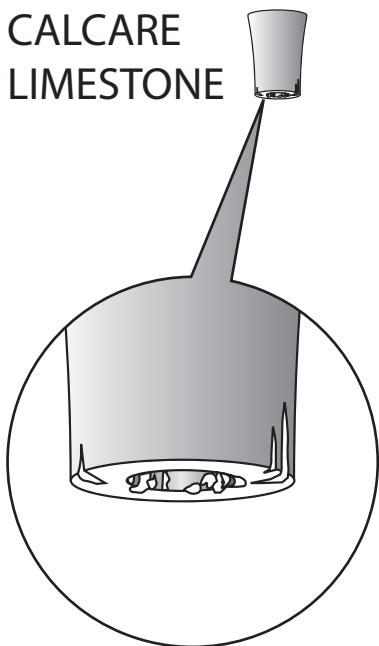

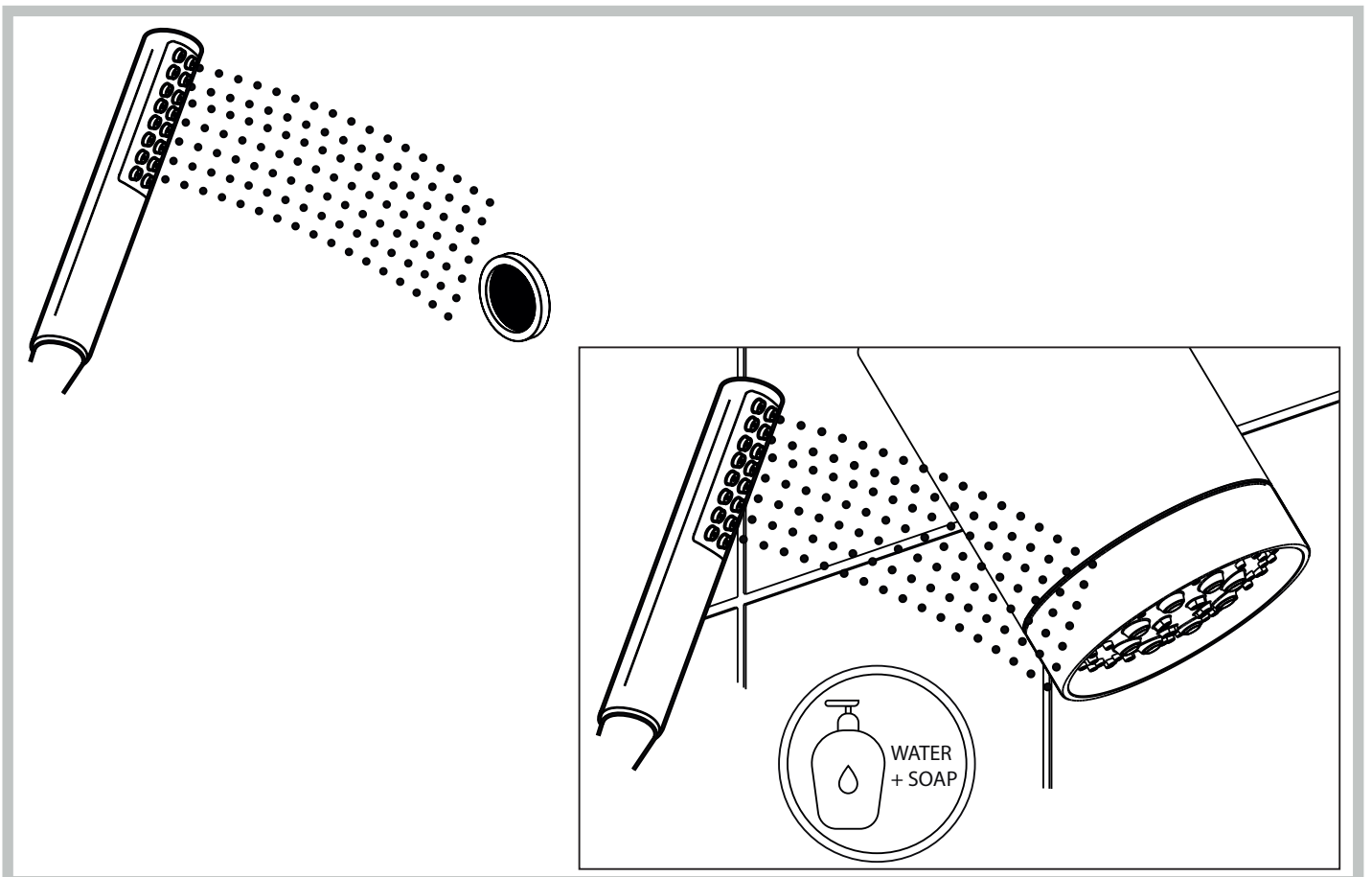
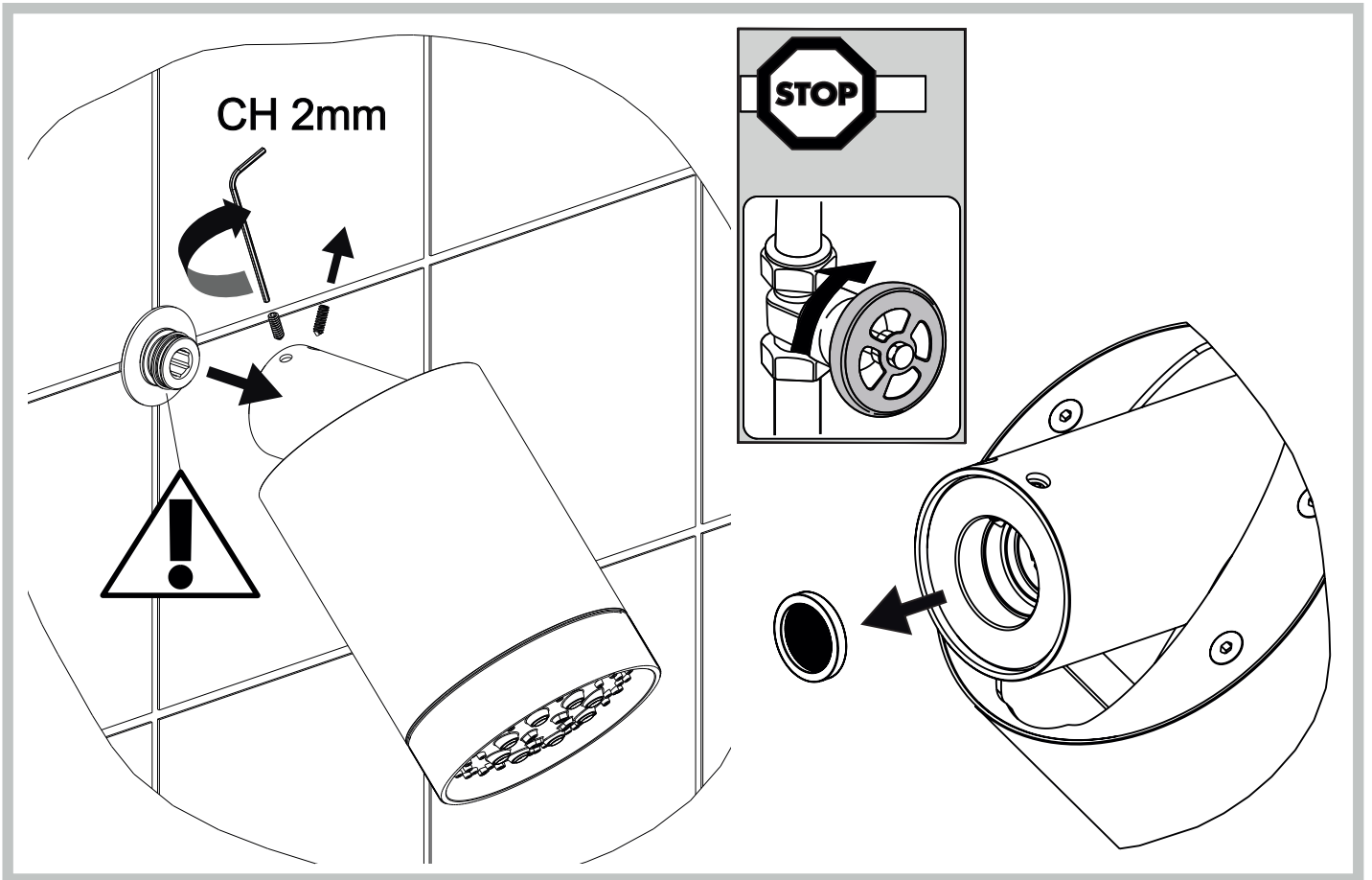















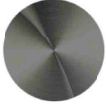











CALCARE
LIMESTONE







CLEANING - PULIZIA - NETTOYAGE - REINIGUNG - LIMPIEZA

Finish		✓			✗	
BS Brushed Steel 316 stainless steel		 WATER ✓	 LIQUID SOAP ✓	 SMOOTH CLOTH ✓	 ACID/ABRASIVE DETERGENT ✗	 ABRASIVE SPONGE ✗
		 WATER ✓	 LIQUID SOAP ✓	 SMOOTH CLOTH ✓	 ACID/ABRASIVE DETERGENT ✗	 ABRASIVE SPONGE ✗
BB Brushed Black PVD finish on stainless steel		 WATER ✓	 LIQUID SOAP ✓	 SMOOTH CLOTH ✓	 ACID/ABRASIVE DETERGENT ✗	 ABRASIVE SPONGE ✗
		 WATER ✓	 LIQUID SOAP ✓	 SMOOTH CLOTH ✓	 ACID/ABRASIVE DETERGENT ✗	 ABRASIVE SPONGE ✗
BC Brushed Copper PVD finish on stainless steel		 WATER ✓	 LIQUID SOAP ✓	 SMOOTH CLOTH ✓	 ACID/ABRASIVE DETERGENT ✗	 ABRASIVE SPONGE ✗
		 WATER ✓	 LIQUID SOAP ✓	 SMOOTH CLOTH ✓	 ACID/ABRASIVE DETERGENT ✗	 ABRASIVE SPONGE ✗

AMPHORA
WATER SOURCE

Via dello Statuario 15
I-55045 Pietrasanta - Italy
info@amphoradesign.it